

Non-Clogging Self-Priming Sewage Pumps

Applications

- Irrigation and Drainage Water
- General purpose

Performance Range

- Capacity : Q up to 600 m³/hr
up to 3000 gpm
- Head : H up to 36m
up to 110 feet
- Temperature : T up to 40 °C
up to 80 °F
- Speed : n 2900rpm

Features

- Stable performance, reliable operation;
- The pump shall be installed on the pedestal. axial suction and radial discharge;
- Back-pull-out construction : Convenient for maintenance and troubleshooting.
Daily maintenance can be performed rapidly by common tools, saving time and labor;
- Semi-open impeller structure and non-clogging design : Big passage capacity.
Diameter of maximum passing grain for SP-6 is 76mm.
- No priming is required except for initial use (first time start).

Standard Materials

Pump casing is made of cast iron or ductile cast iron, impeller can be cast iron or optional stainless steel.

Model Code

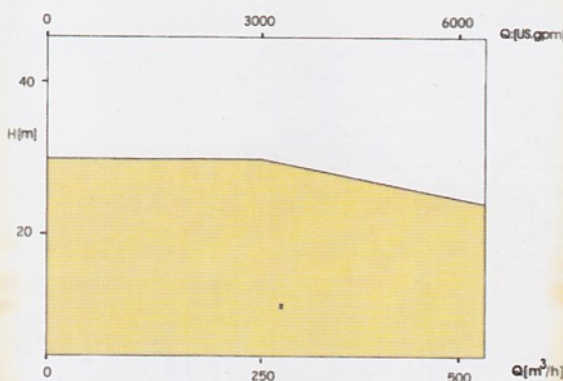
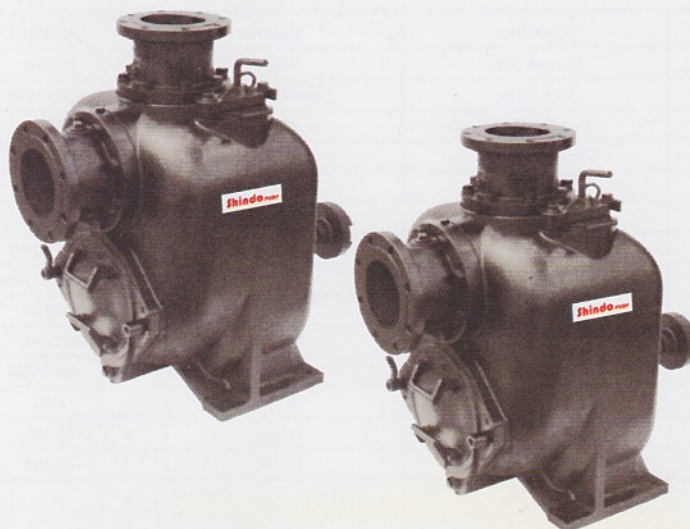
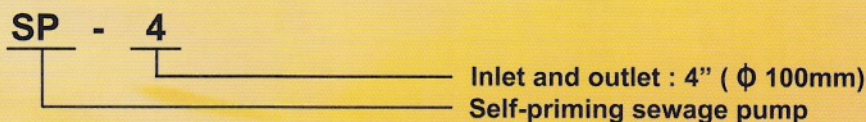

Spare parts list

NO	Parts Name	Material	AISI/SAE
1	Suction Inlet	HT200	No35B
2	Flap valve	NBR+Q235A	NBR+1035
3	Infusion Cover	HT200	NO35B
4	Discharge Outlet	HT200	NO35B
5	End Cover	HT200	NO35B
6	Wear Plate	45	1045
7	Impeller	QT400-18 or 304s.s	A60-40-18
8	Volute	HT200	No35B or 304s.s
9	Seal Base	HT200	No35B
10	Cartridge mechanical seal	WC/WC	WC/WC
11	O-Ring	NBR/FPM	NBR/FPM
12	Shaft	2Cr13	410
13	Bearing Body	HT200	No35B
14	Bearing Cover	HT200	No35B

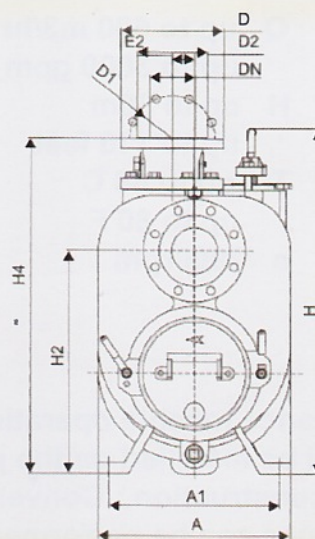
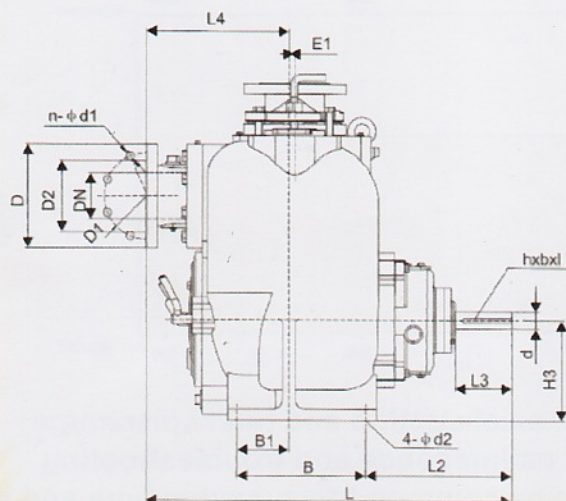
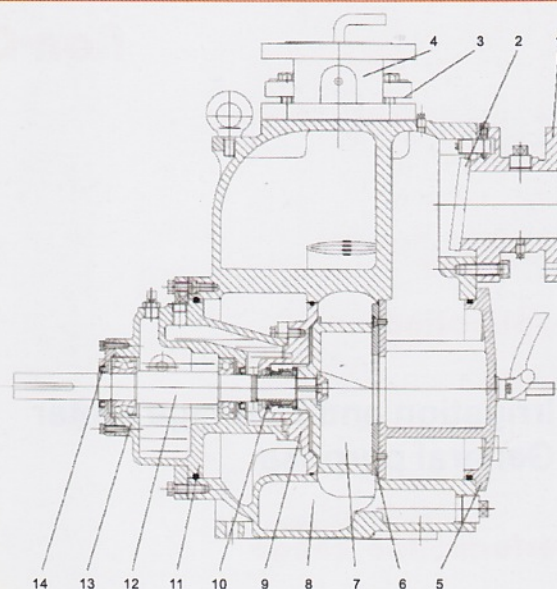

Item		SP-3		SP-4		SP-6	
		Metric	English	Metric	English	Metric	English
Suction & Discharge	DN	3" (76)(PN0.6MPa)		4" (100)(PN1.0MPa)		6" (152.5)(PN1.0MPa)	
	D	190		220	9" (228.6)	285	11" (279.4)
	D1	152		180	7.5" (190.5)	240	9.5" (241.3)
	D2	128		158		214	
	N-φd1	4-φ18		8-φ18		8-φ21	
Installation Dimension	H2	431.8		495.3		574.3	
	A	377		428		580	
	A1	328		373		527	
	B	228.6		279.4		279.4	
	B1	76.2		110		77.8	
	L2	285		326		294	
	d2	φ18		φ18		φ18	
	H3	190.5		222.2		257.2	
	L3	102		127		127	
	d	φ38	φ1.5"(38.1)	φ38	φ1.5"(38.1)	φ38	φ1.5"(38.1)
Profile Dimension	Hxbxl	10×5×80	38×19×3.0	10×5×90	38×19×3.50	10×5×90	38×19×3.50
	H	697.5		760		875	
	H4	652		735		887.7	
	L	712.2		813.5		906.6	
	L4	277		318		411	
	E1	15		13		0	
	E2	50		50		50	
(Kg)/Weight		190		275		438	