

MHB-CK Mechanically Sealed Slurries Pump

Flow (m ³ /hr)	5 - 1,920
Max. Head (m)	13 - 53
Temperature (°C)	-20°C - 80°C
Design	Back Pull Out End Suction Coupling
Features	PFA Lined, Semi-Open Impeller

* PFA-Perfluoroalkoxy, Teflon-PFA



• Application •

Petrochemical, Chemical Processing, Bulk Unload & Transfer, Plating Recirculation / Filtration, PCB Etching / Rinse, Fumes Scrubber, Waste Water Treatment, Electronics Manufacturing, Underground Storage Tank, Top Opening Tank, Sumps, Pharmaceutical & Photo Processing, Slurry Waste, Abrasives Waste, Scale & Sediments, High Viscosity Liquid And Any Hazardous Chemical Applications...

• Design Features •

Concentric casing with tangential discharge nozzle design. The impeller and casing is equal at all points. This will reduce turbulence, cavitation and casing life is greatly extended especially in abrasive service. Non-clogging semi-open vane impeller, ideal for handling liquids containing suspended matter or solids. The impeller also consists of multi back vanes to reduce the concentration of solids and also lower the pressure on the sealing chamber area. Closed impeller, fully-open impeller and torque flow impeller also available on request.

Performance Curve

Performance Curve Base On Clean Water (20°C)

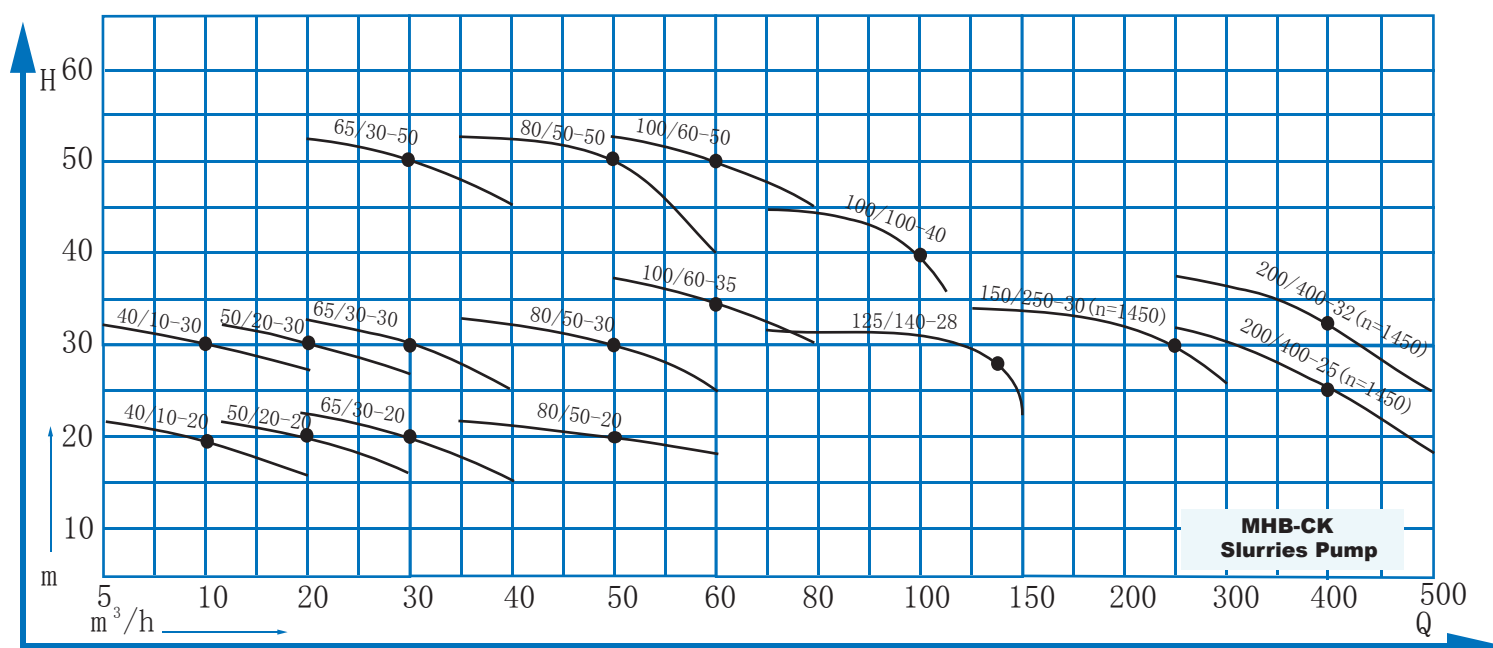

Note : All specifications subject to change without prior notice.

Performance Curve

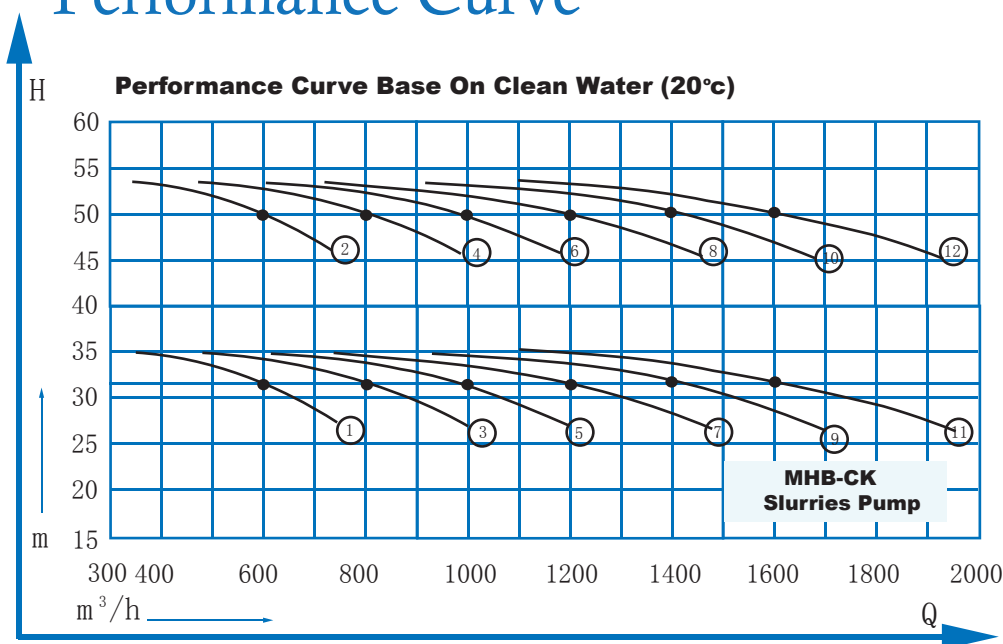

No	Item
1	MHB-CK250 / 600-32
2	MHB-CK250 / 600-50
3	MHB-CK250 / 800-32
4	MHB-CK250 / 800-50
5	MHB-CK300 / 1000-32
6	MHB-CK300 / 1000-50
7	MHB-CK300 / 1200-32
8	MHB-CK300 / 1200-50
9	MHB-CK350 / 1400-32
10	MHB-CK350 / 1400-50
11	MHB-CK350 / 1600-32
12	MHB-CK350 / 1600-50

Structure Diagram & Material

• For Pump Inlet / Discharge Less Than 250mm Diameter.

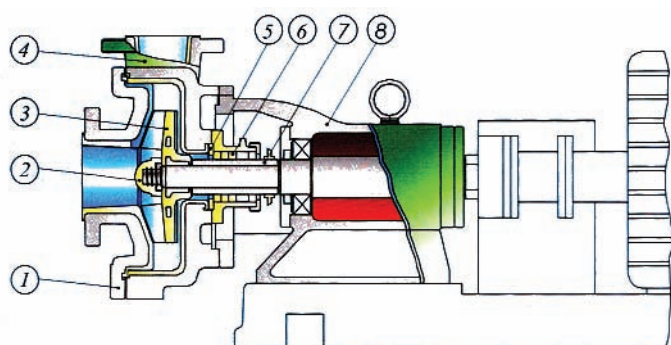

No	Structure	Material
1	Pump Housing	PFA Lined / HT200
2	Impeller Nut	PFA
3	Impeller	PFA
4	Pump Body	PFA Lined / HT200
5	Seal Cover	PFA
6	Sealing	Teflon
7	Shaft	Silicon Nitride
8	Pump Bracket	HT200

* PFA-Perfluoroalkoxy, Teflon-PFA

• For Pump Inlet / Discharge More Than 250mm Diameter.

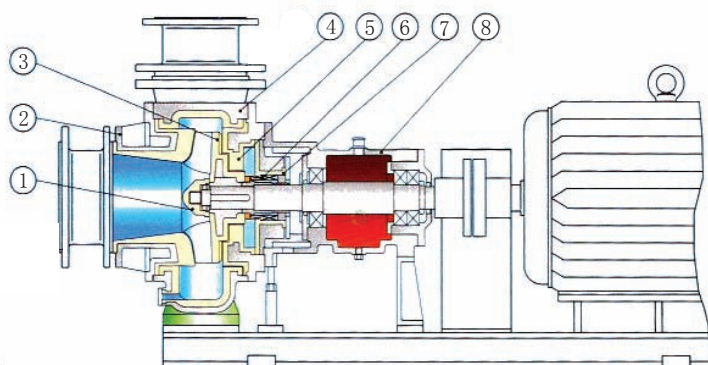

No	Structure	Material
1	Impeller Nut	PFA
2	Pump Body	PFA Lined / HT200
3	Impeller	PFA
4	Pump Body	PFA Lined / HT200
5	Pump Back Cover	PFA Lined / HT200
6	Mechanical Seal	Teflon
7	Seal Cover	PFA Lined / HT200
8	Pump Bracket	HT200

* PFA-Perfluoroalkoxy, Teflon-PFA

Note : All specifications subject to change without prior notice.



Type Keys

MHB-CK 50 / 50 - 20 - 20

Head 20m
Capacity 20m³/h
Discharge
Semi Open Impeller
Slurry with Solid
Solid Abrasives Pump

Specifications

No	Model	Flow Rate (m ³ /hr)	Head (m)	Efficiency (%)	NPSH (m)	Inlet/Outlet Diameter (mm)	Speed (r/min)	Power (kw)	kg
1	MHB-CK40/10-20	5	22	18	3.0	40X32	2900	3	100
		*10	20	28					
		12	18	30					
2	MHB-CK40/10-30	5	32	18	3.0	40X32	2900	4	105
		*10	30	36					
		12	27	30					
3	MHB-CK50/20-20	12	22	30	3.0	50X40	2900	4	130
		*20	20	37					
		25	17	40					
4	MHB-CK50/20-30	12	32	30	3.0	50X40	2900	5.5	150
		*20	30	36.5					
		25	28	40					
5	MHB-CK65/30-20	20	13	34	3.5	65X50	2900	5.5	150
		*30	20	36					
		35	18	40					
6	MHB-CK65/30-30	20	32	34	3.5	65X50	2900	7.5	150
		*30	30	37					
		35	18	40					
7	MHB-CK65/30-50	20	52	30	3.5	65X50	2900	15	280
		*30	50	35.5					
		35	47	38					
8	MHB-CK80/45-35	30	37	33	3.5	80X65	2900	15	260
		*45	35	40					
		55	30	36					
9	MHB-CK80/50-20	35	22	32	4.0	80X65	2900	11	262
		*50	20	39					
		60	17	30					
10	MHB-CK80/50-30	35	32	33	3.5	80X65	2900	15	260
		*50	30	40					
		60	25	36					
11	MHB-CK80/50-50	35	52	33	4.0	80X65	2900	18.5	280
		*50	50	41					
		55	45	38					
12	MHB-CK100/60-35	50	37	38	4.0	100X80	2900	18.5	345
		*60	35	40					
		80	30	42					
13	MHB-CK100/60-50	50	52	37	4.0	100X80	2900	22	380
		*60	50	40					
		70	45	42					
14	MHB-CK100/100-40	70	45	41	4.0	100X80	2900	30	440
		*100	40	40					
		110	35	33					

Note : All specifications subject to change without prior notice.



Specifications

No	Model	Flow Rate (m ³ /hr)	Head (m)	Efficiency (%)	NPSH (m)	Inlet/Outlet Diameter (mm)	Speed (r/min)	Power (kw)	kg
15	MHB-CK125/140-28	70	32	35	5.0	125X100	2900	30	400
		*140	28	46					
		150	22	35					
16	MHB-CK150/250-30	120	34	45	4.0	150X125	1450	45	840
		*250	30	55					
		300	26	50					
17	MHB-CK200/400-25	240	28	55	5.5	200X150	1450	75	1180
		*400	25	64					
		500	20	60					
18	MHB-CK200/400-32	240	39	55	5.5	200X150	1450	75	1180
		*400	32	62					
		500	26	60					
19	MHB-CK250/600-32	360	35	71	6	250X200	1450	110	
		*600	32						
		720	28						
20	MHB-CK250/600-50	360	53	69	6	250X200	1450	132	
		*600	50						
		720	46						
21	MHB-CK250/800-32	480	35	72	7.4	250X200	1450	132	
		*800	32						
		960	28						
22	MHB-CK250/800-50	480	53	70	7.6	250X200	1450	200	
		*800	50						
		960	46						
23	MHB-CK300/1000-32	620	35	72	8.5	300X250	1450	160	
		*1000	32						
		1200	28						
24	MHB-CK300/1000-50	620	53	71	8.5	300X250	1450	250	
		*1000	50						
		1200	46						
25	MHB-CK300/1200-32	760	35	73	9.5	300X250	1450	200	
		*1200	32						
		1440	28						
26	MHB-CK300/1200-50	760	53	72	9.6	300X250	1450	315	
		*1200	50						
		1440	46						
27	MHB-CK350/1400-32	920	35	72	6.1	350X300	980	250	
		*1400	32						
		1680	27						
28	MHB-CK350/1400-50	920	53	70	6.1	350X300	980	355	
		*1400	50						
		1680	45						
29	MHB-CK350/1600-32	1100	35	72	6.7	350X350	980	250	
		*1600	32						
		1920	27						
30	MHB-CK350/1600-50	1100	53	71	6.7	350X350	980	400	
		*1600	50						
		1920	45						

Note : All specifications subject to change without prior notice.

Dimensions

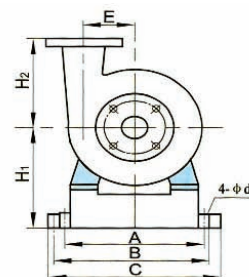
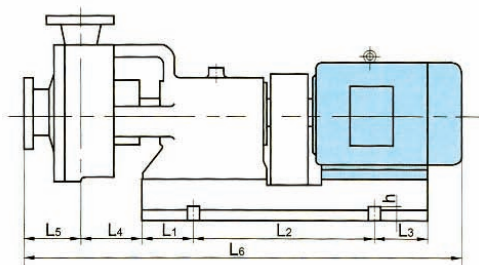

Model	A	B	C	E	H ₁	H ₂	L ₁	L ₂	L ₃	L ₄	L ₅	L ₆	h	4-φd
MHB-CK40/10-20	260	260	300	93	170	165	120	330	130	110	135	900	20	4-φ18
MHB-CK40/10-30	250	300	325	93	162	165	75	455	75	110	135	960	15	4-φ18
MHB-CK50/20-20	320	340	380	95	212	176.5	175	400	175	90	116	1020	22	4-φ20
MHB-CK50/20-30	320	340	380	95	212	176.5	175	400	175	90	116	1060	22	4-φ20
MHB-CK65/30-20	320	340	380	125	212	220	175	400	175	105	120	1070	25	4-φ20
MHB-CK65/30-30	320	340	380	125	212	220	175	400	175	105	120	1070	25	4-φ20
MHB-CK65/30-50	320	400	425	125	278	220	150	530	180	110	120	1075	25	4-φ30
MHB-CK80/45-35	320	400	425	125	278	220	150	530	180	110	130	1105	25	4-φ30
MHB-CK80/50-20	320	400	425	125	278	220	150	530	180	110	130	1105	25	4-φ30
MHB-CK80/50-30	320	400	425	125	278	220	150	530	180	110	130	1105	25	4-φ30
MHB-CK80/50-50	320	400	425	125	278	220	150	530	180	110	130	1405	25	4-φ30
MHB-CK100/60-35	385	480	540	130	318	225	188	705	263	115	130	1405	30	4-φ25
MHB-CK100/60-50	385	480	540	130	318	225	188	705	263	115	130	1430	30	4-φ25
MHB-CK100/100-40	385	480	540	130	318	225	188	705	263	115	130	1530	30	4-φ25
MHB-CK125/140-28	395	485	560	131	308	218	210	670	210	140	164	1395	40	4-φ30
MHB-CK150/250-30	500	600	660	225	370	470	250	935	245	100	365	1990	50	4-φ30
MHB-CK200/400-25	510	660	750	235	395	470	245	1000	340	106	370	2166	50	4-φ30
MHB-CK200/400-32	510	660	750	235	395	470	245	1000	340	106	370	2166	50	4-φ30

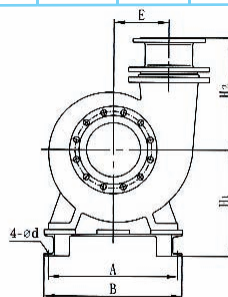
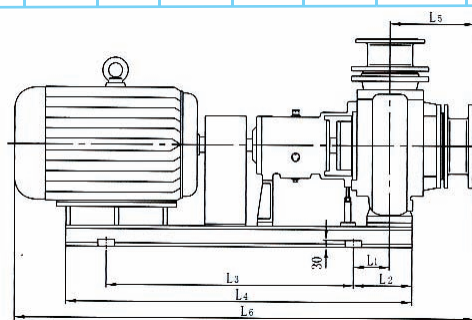

Model	A	B	E	H ₁	H ₂	L ₁	L ₂	L ₃	L ₄	L ₅	L ₆	4-φd
MHB-CK250/600-32	600	640	255	490	520	175	285	1200	1750	410	2465	4-φ24
MHB-CK250/600-50	600	640	302	545	570	175	285	1200	1850	410	2470	4-φ24
MHB-CK250/800-32	600	640	255	490	520	175	285	1200	1800	410	2495	4-φ24
MHB-CK250/800-50	600	640	302	545	570	175	285	1200	1850	410	2495	4-φ24
MHB-CK300/1000-32	590	640	300	605	575	175	300	1350	1940	410	2570	4-φ26
MHB-CK300/1000-50	650	700	320	630	600	175	300	1500	2035	410	2800	4-φ26
MHB-CK300/1200-32	590	640	300	605	575	175	300	1350	1940	410	2570	4-φ26
MHB-CK300/1200-50	650	700	320	630	600	175	300	1500	2105	410	2800	4-φ26
MHB-CK350/1400-32	650	700	390	690	650	190	330	1500	2135	425	2830	4-φ26
MHB-CK350/1400-50	840	900	430	770	700	190	330	1020x2	2800	425	3680	4-φ33
MHB-CK350/1600-32	650	700	390	690	650	190	330	1500	2135	425	2830	4-φ26
MHB-CK350/1600-50	840	900	430	770	700	190	330	1020x2	2800	425	3680	4-φ33

Note : All specifications subject to change without prior notice.

Dimensions

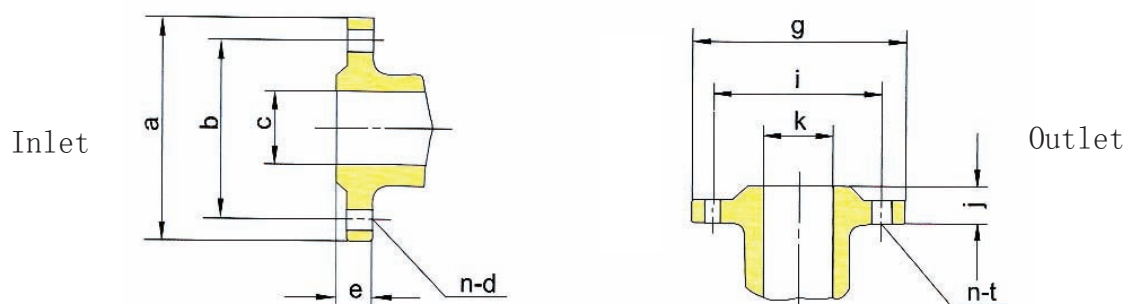

Model	Inlet					Outlet				
	c	a	b	e	4- ϕ d	k	g	i	j	n- ϕ t
MHB-CK40/10-20	40	150	110	20	4- ϕ 14	32	140	110	20	4-M16
MHB-CK40/10-30	40	150	110	20	4- ϕ 14	32	140	110	20	4-M16
MHB-CK50/20-20	50	140	110	23	4- ϕ 14	40	130	100	23	4- ϕ 14
MHB-CK50/20-30	50	140	110	23	4- ϕ 14	40	130	100	23	4- ϕ 14
MHB-CK65/30-20	65	180	145	25	4- ϕ 18	50	140	110	23	4- ϕ 14
MHB-CK65/30-30	65	180	145	25	4- ϕ 18	50	140	110	23	4- ϕ 14
MHB-CK65/30-50	65	180	145	25	4- ϕ 18	50	140	110	23	4- ϕ 14
MHB-CK80/45-35	80	195	160	27	4- ϕ 18	65	185	145	25	4- ϕ 18
MHB-CK80/50-20	80	195	160	27	4- ϕ 18	65	185	145	25	4- ϕ 18
MHB-CK80/50-30	80	195	160	27	4- ϕ 18	65	185	145	25	4- ϕ 18
MHB-CK80/50-50	80	195	160	27	4- ϕ 18	65	185	145	25	4- ϕ 18
MHB-CK100/60-35	100	220	180	29	4- ϕ 18	80	195	160	27	8- ϕ 18
MHB-CK100/60-50	100	220	180	29	8- ϕ 18	80	195	160	27	8- ϕ 18
MHB-CK100/100-40	100	220	180	29	8- ϕ 18	80	195	160	27	8- ϕ 18
MHB-CK125/140-28	125	245	210	26	8- ϕ 18	100	220	180	30	8- ϕ 18
MHB-CK150/250-30	150	270	240	22	8- ϕ 18	125	245	210	22	8- ϕ 23
MHB-CK200/400-25	200	335	295	22	8- ϕ 23	150	280	240	20	8- ϕ 23
MHB-CK200/400-32	200	335	295	22	8- ϕ 23	150	280	240	20	8- ϕ 23
MHB-CK250/600-32	250	405	355	28	8- ϕ 23	200	335	263	21	12- ϕ 23
MHB-CK250/600-50	250	405	355	28	12- ϕ 28	200	335	263	21	12- ϕ 23
MHB-CK250/800-32	250	405	355	28	12- ϕ 28	200	335	263	21	12- ϕ 23
MHB-CK250/800-50	250	405	355	28	12- ϕ 28	200	335	263	21	12- ϕ 23
MHB-CK300/1000-32	300	460	410	28	12- ϕ 28	250	405	355	21	12- ϕ 28
MHB-CK300/1000-50	300	460	410	28	12- ϕ 28	250	405	355	21	12- ϕ 28
MHB-CK300/1200-32	300	460	410	28	12- ϕ 28	250	405	355	21	12- ϕ 28
MHB-CK300/1200-50	300	460	410	28	12- ϕ 28	250	405	355	21	12- ϕ 28
MHB-CK350/1400-32	350	520	470	28	12- ϕ 28	300	460	410	21	12- ϕ 28
MHB-CK350/1400-50	350	520	470	28	16- ϕ 28	300	460	410	21	12- ϕ 28
MHB-CK350/1600-32	350	520	470	28	16- ϕ 28	300	460	410	21	12- ϕ 28
MHB-CK350/1600-50	350	520	470	28	16- ϕ 28	300	460	410	21	12- ϕ 28